

PREKLAD

dne: 17. 12. 2014

PROVEDL/A

*UŠTA LP*

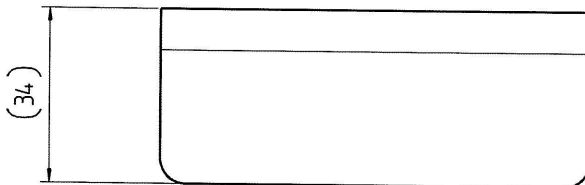
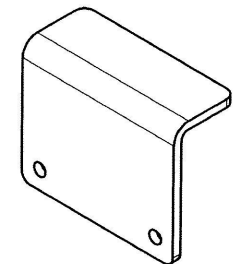
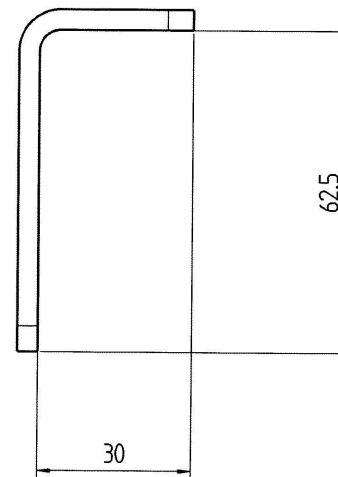
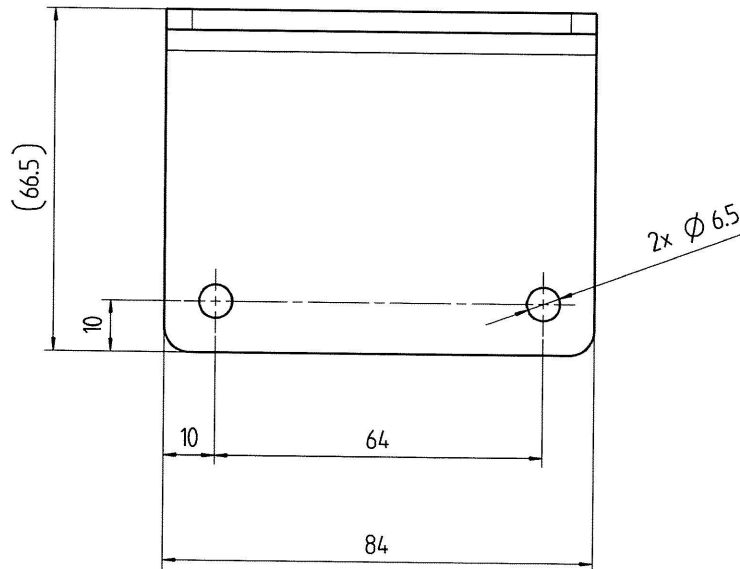

- 2 -03- 2015  
ARCHIV

1

*TRUSKLA OROŠ.  
NEWOT. NAŠIVSY  
NAŠIVS ONYBL*

NOTA :

- Metal sheet thickness : 4 mm
- Radii without dimension : R = 5
- Bend radii : R = 4

PL00132.gr1

LASER cutting tolerances					
NOTA : min cutting radius without dimensions R = 1 mm unless otherwise specified					
≤ 30	30 < ≤ 120	120 < ≤ 400	400 < ≤ 1000	1000 <	
± 0,5	± 0,8	± 1,0	± 1,5	± 2,0	$\begin{matrix} +0.5 \\ -0.5 \end{matrix}$

*NE 14/01402*

First angle projection	01	oiled --> oiled permissible	T48720		
General tolerance (GT) in mm	Index	alteration	Change no	Fit	Toler.
Size range	Inspection dim.	Auxiliary dim.	Date	Name	Material: S235JR following EN10025-2
≤ 30	> 30	> 120	> 400	> 1000	Blank no:
≤ 30	≤ 120	≤ 400	≤ 1000		Title:
GT coarse	L	1	2	3	4
	< 1	1	2	4	6
Lengths (L) and angle (L/Δ) = ± GT	Drawn	9.12.2013	J.Fonteny	Checked	13.12.2013
Tolerance Symbols ISO 1101	Auth'd	20.12.2013	R.Pelletier	M.check	13.1.2014
○ roundness = 1/20-Tol.					
□ straightness/flatness = GT					
⊙ concentricity/run out = GT					
≡ symmetry = GT					
// parallelism = GT					
⊕ position = GT					
Languages: en,fr	Confidential document	Refer to protection notice ISO 16061	Repl.	Orig.	
Condition at time of delivery	de-scaled (degree of purity SA 2 1/2 acc. ISO 8501-1)	X	without burrs acc. WN 11310	Permissible top-end rounding during flame cutting (also positive bead acc. WN 10572)	oil-free / free of grease
oiled			oiling permissible	X	Indicate the required condition at time of delivery with an X.
Weight: in kg	0.2	PROD. Scale 1:1	Sheet: 1 of: 1	Drawing number	11914.010904

Released

11914.010904.d001

A3